

WPBX Wireless DECT Beltpack

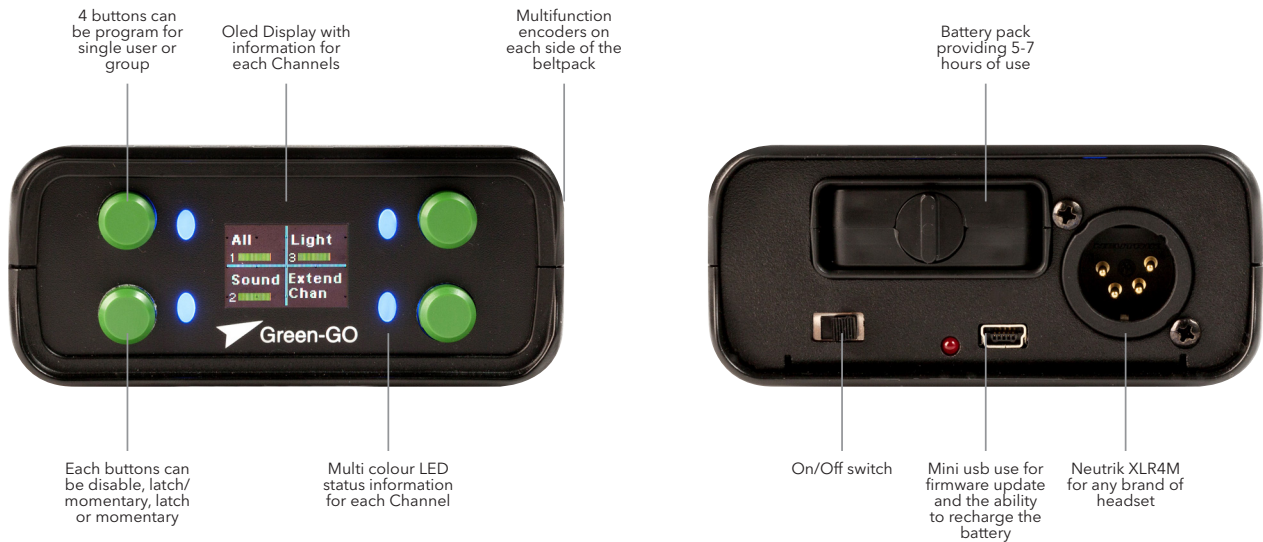

The WPBX Wireless Beltpack uses DECT wireless technology to communicate with the WAA antenna, providing the same features and flexibility that you're already familiar with from the Green-GO wired system. This allows for users to seamlessly switch from wired to wireless without having to learn a new system. Each WPBX Wireless Beltpack can be paired with up to four WAA antennas to extend the range as required.

The WPBX Wireless Beltpack provides direct access to up to 4 Channels. The 4 buttons can be used either all be used as talk buttons, or as a combination of talk and call buttons (in the combination 2/2 or 3/1). A simple press of the button will toggle (Latch), while a long press will temporarily activate the voice connection (PTT). A simple key combination enables the user to enter the extended Channel mode, where there's access to all 32 available Channels.

A high-contrast OLED display displays text messages, light and call signs as well as status messages clearly in any environment. Incoming call signals are indicated by a red / white flashing display, while alarm signals can additionally activate an alarm tone if desired. Two multi-function encoders on the sides of the unit complete the hardware features, providing multiple functions including volume control. All settings can be made either on the device itself via the integrated display or via the free Green-GO Control Software.

The WPBX Wireless Beltpack comes with a battery life of 5-7 hours and can be operated or charged via the mini usb port. A separate charging station is not mandatory.

Technical Data

- Dimension: 95mm x 119mm x 42mm
- Weight: 345 g with battery
300g with-out
- Connections: 1 x Neutrik XLR4M,
1 x Mini usb
- Controls: 1 x OLED colour Display,
4 Buttons, 2 x Multi-Function Encoders, On/Off switch, LED Status Indicator
- Power Supply: 1800mAh Lithium-Ion Battery Pack

Article Reference

GGO-WBPX
NRGP Battery

Accessory

GHSA05 Telephone Style



WAA Wireless Antenna



The Green-GO Wireless Antenna is part of the Green-GO wireless communication system and is based on DECT technology. One Wireless Antenna serves up to four Wireless Beltpacks and each Wireless Beltpack X can be connected to four Wireless Antennas. The Green-GO Wireless Antenna can also integrate the Wireless Beltpack X into an existing wired network by simply plugging in the Wireless Antenna and cloning the configuration to the Wireless Beltpack(s).

The Wireless Antenna is powered through either the Power over Ethernet port or the mini usb connector, both of which are located on the back of the device.

Technical Data

- Dimension:
 - 95mm x 119mm x 42mm
- Weight: 220g
- Connections: 1 x 10/100Mbps Neutrik RJ45 EtherCON, 1 x Mini usb
- Controls: 1 x Button, 1 x LED Status Indicator
- Power Supply: PoE (802.3af)
- 3/8 Ww thread for pole mounting

Article Reference

GGO-WAA