



Titan Tube is the ultimate LED tube for filmmakers, studios, event technician and any creative person. It emits powerful, tunable whites with ultra-high color rendering as well as colored light which can be applied to individual pixels or the whole tube. The tube offers unlimited range of usage; indoor or outdoor, AC-powered or on battery, on the go with the AsteraApp, with wired or wireless DMX.

**Max 20h****Wireless DMX****IP65****App**

## SPECIFICATIONS

Please note that due to a component shortage we had to do internal changes to Titan Tube and units manufactured after September 2021 have the BTB feature built-in and are now called FP1-BTB.

	<b>Titan Tube</b>	<b>Titan Tube BTB</b>
Order Code	FP1	FP1-BTB
LED Engine	Titan LED Engine	
Colors	RGBMintAmber	
Total LED Power	72 W	
LED Power Draw	48 W	
Luminous Flux 3200K	2535 Lumens	
Luminous Flux 4000K	2900 Lumens	
Light Output 3200 K @ 1m	708 Lux	
Light Output 4000 K @ 1m	785 Lux	
Light Output 5500 K @ 1m	Not Available	
CRI (Ra)/ TLCI 3200- 6500 K*	≥96	
Beam Angle	135° x 115°	
Field Angle	175° x 160°	
Strobe	0 - 25 Hz	
Pixels	16	
Battery Runtime	up to 20 hours	
Battery Runtime Max Brightness	1h 45m	
Battery Lifetime	70 % after 300 cycles	
Charging Time (nominal)	3 hours	
DC Input	24 VDC - 2 A	
DC Connector	5.5 mm x 2.1 mm	
AC Input	No	
AC Connector	No	
Power Consumption (max.)	TBC	
Wired DMX	Yes	
CRMX Receiver	Built-in	
BluetoothBridge BTB	No	Built-in
Wireless Protocols	CRMX, UHF	CRMX, UHF, Bluetooth, WiFi

\*Typical value

Wireless Range	CRMX/UHF up to 300 m / 330 yds	CRMX/UHF up to 300 m / 330 yds Bluetooth up to 3 m / 3.3 yds
Infrared Control	Yes	
ControlSync	No	
TouchSlider	No	
Housing Material	Polycarbonate, metal end caps	
IP Rating	IP65 (only with FP1-SP)	
Ambient Operating Temperature	0 - 40 °C / 32 - 104 °F	
Weight	1.35 kg / 3 lbs	
Dimensions	Ø43 mm x 1035 mm/ Ø1.7" x H40.7"	
Mounting Options	2x M5 thread, 2x Holder (with 2x M5 and 1x 1/4" -20UNC thread), 1x TubeStand"	

## RF CHARACTERISTICS FP1

Wireless Modules	EU: UHF*** (863-870MHz)	USA: UHF (917-922.20MHz)	AUS: UHF (922.30-927.50MHz)	SGP: UHF (920.50-924.50MHz)	KOR: UHF (917.9-921.5MHz)
Modulation	FHSS	FHSS	FHSS	FHSS	FHSS
ERP (Transmitter)	<25mW	<25mW	<25mW	<25mW	<25mW
Channel Count	47	53	53	41	10

Wireless Modules	RUS: UHF (868.75-869.12MHz)	JPN: UHF (922.80-926.40MHz)	CRMX (2402-2480MHz)
Modulation	FHSS	FHSS	FHSS
ERP (Transmitter)	<25mW	<25mW	-
Channel Count	6	19	79

\*\*\*General allocation of frequencies for use by short-range radio applications

## RF CHARACTERISTICS FP1-BTB



Wireless Modules	EU: UHF*** (863-870MHz)	USA: UHF (917-922.20MHz)	AUS: UHF (922.30-927.50MHz)	SGP: UHF (920.50-924.50MHz)	KOR: UHF (917.9-921.5MHz)
Modulation	FHSS	FHSS	FHSS	FHSS	FHSS
ERP (Transmitter)	<25mW	<25mW	<25mW	<25mW	<25mW
Channel Count	47	53	53	41	10

Wireless Modules	RUS: UHF (868.75-869.12MHz)	JPN: UHF (922.80-926.40MHz)	CRMX (2402-2480MHz)	Bluetooth 5.0 LE (2402-2480MHz)	WiFi (2412-2472MHz)
Modulation	FHSS	FHSS	FHSS	FHSS	DSSS, OFDM
ERP (Transmitter)	<25mW	<25mW	-	10mW (BLE)	100mW
Channel Count	6	19	79	40	13

\*\*\*General allocation of frequencies for use by short-range radio applications

## DRAWINGS

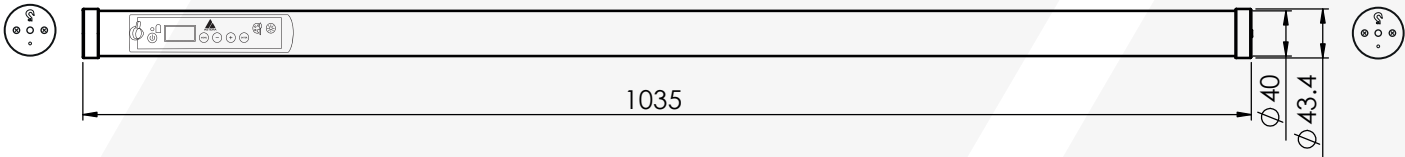

## CONNECTIONS + DISPLAY

Wired Data Connection  
Backside Display

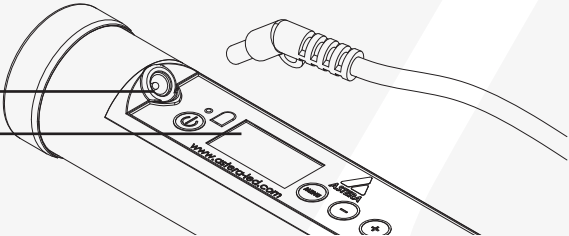



# DATASHEET

# Titan PowerBox

Compatible with:  
FP1 Titan Tube, FP2 Helios Tube, PB15 PixelBrick

Date: 01/28/21 Version: 1.0



Power supply for charging 8 Titan Tubes or Helios Tubes at the same time. Also works as a converter for DMX, Art-NET and sCAN. Including 1 Powercon True1 cable and 8 short DC cables.

### In the box

- 1 x Power supply box
- 8 x DC power cords
- 1 x PowerCon True1 AC cable

### Accessories

- Power Data Combination Cables
- 5m: FP1-PWB-CAB-5
  - 10m: FP1-PWB-CAB-10
  - 15m: FP1-PWB-CAB-15

## SPECIFICATIONS

Order Code EU	FP1-PWB-EU
Order Code US	FP1-PWB-US
Order Code UK	FP1-PWB-UK
Order Code CH	FP1-PWB-CH
Order Code AU	FP1-PWB-AU
Input	90~250VAC
Input Current	4.4A@115VAC, 3A@230VAC
Output	10 x 24V/2A
Output Connectors	10x DC Barrel 5.5/2.1mm
Power IN / Power OUT	PowerCon True1
Data Input	XLR-DMX; ART-Net (1 Universe); sACN (1 Universe) IP Address can be selected between 2.x, 10.x and DHCP. Universe ID can be set by web-interface or pushbutton (by button only 1-16).
Data Output	DMX via DC sockets
Data sockets	5-pin XLR in+out; RJ45 input
IP Rating	IP20
Dimensions (mm/inch)	321 x 90.7 x 125/ 12.6 x 3.6 x 4.9
Weight (kg/lbs)	3.8 / 8.37
Material	Aluminium

## DRAWINGS

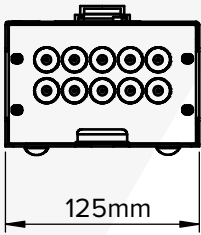
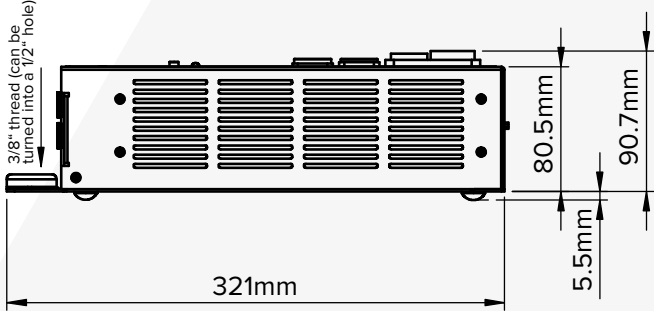

## USE CASE

### PowerBox in the set



# CHARGING & CONNECTING

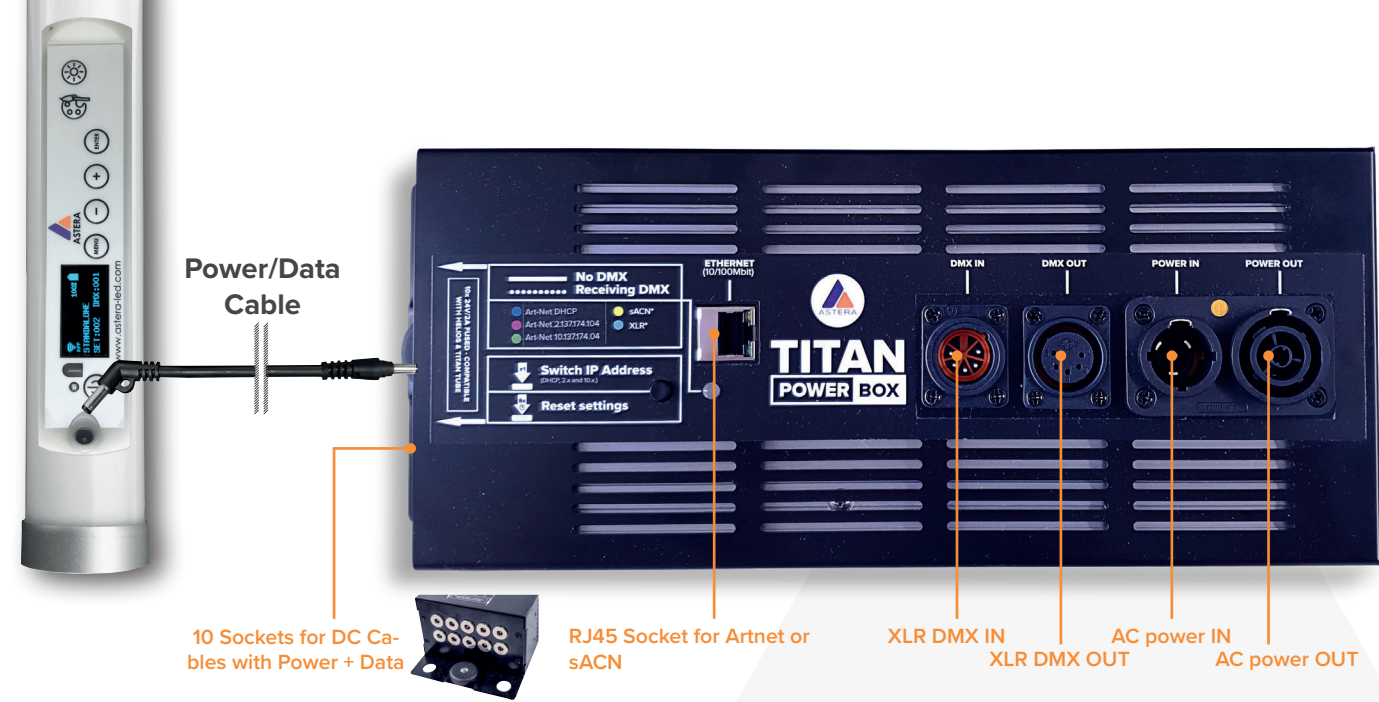

## CONNECTING MULTIPLE DMX UNIVERSES TO 1 POWERBOX

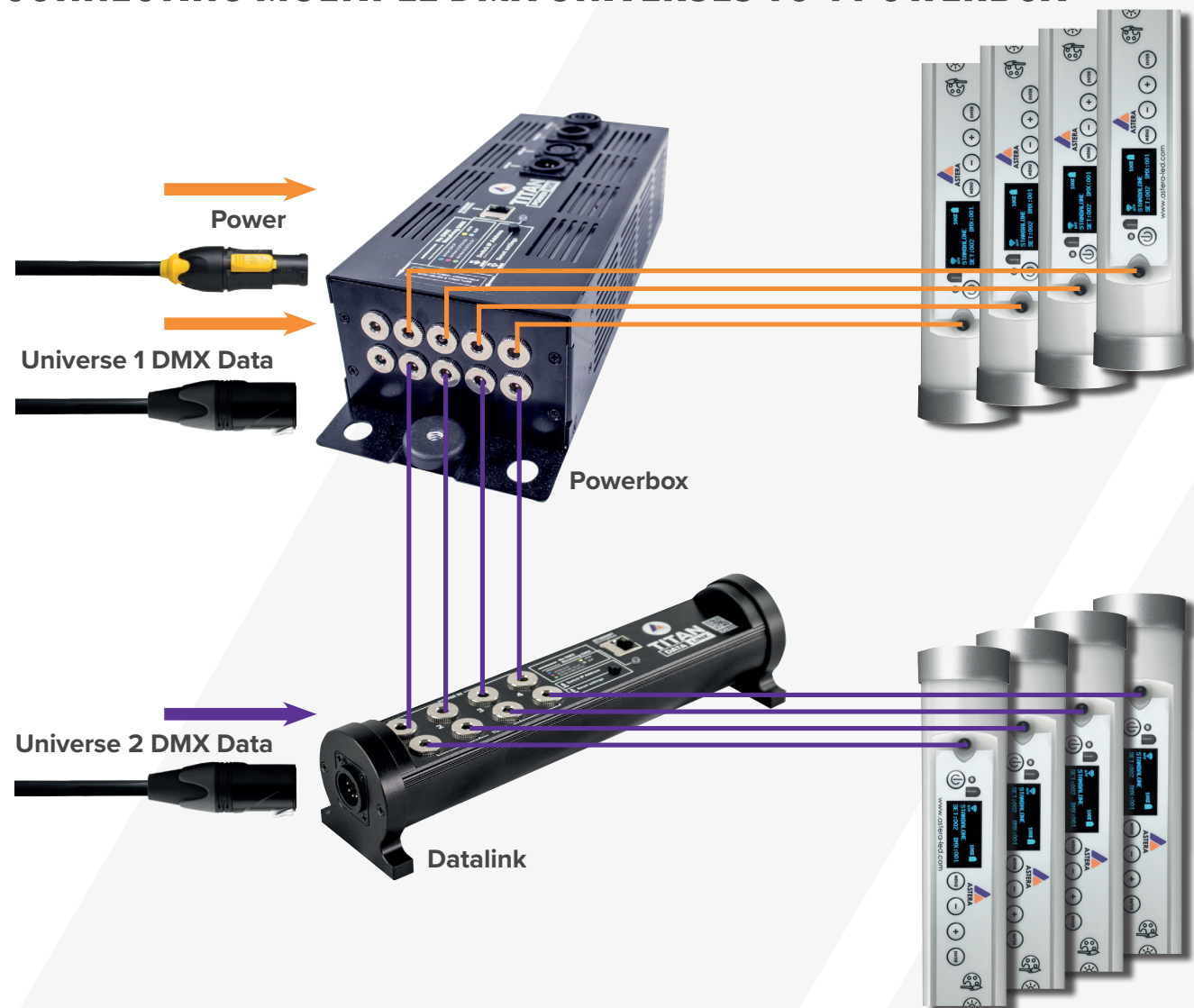



# DATASHEET

## M5 EyeBolt

Compatible with:  
AX1 Pixel Tube, FP1 Titan Tube,  
FP2 Helios Tube, FP3 Hyperion Tube

Date: 01/28/21 Version: 1.0



For suspending AX1 Pixel Tube, Helios Tube, Titan Tube, Hyperion Tube and for securing the 4 tubes via a safety wire.

### SPECIFICATIONS

Order Code	FP1-EBLT
Inner diameter (mm/inch)	Ø12 / Ø0.47
Outer diameter (mm/inch)	Ø21 / Ø0.83
Thread	M5
Weight (kg/lbs)	0.011 / 0.024
Material	Stainless Steel / Adjust ring (rubber)

### DRAWINGS

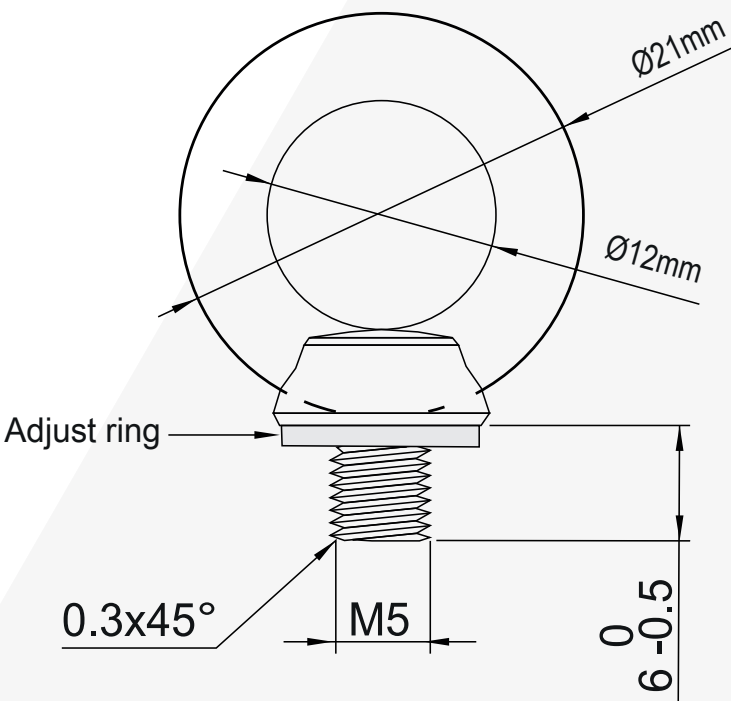

### USE CASES

Eyebolt for hanging  
/ safety via Holder







# DATASHEET

## TubeHolder

Compatible with:  
AX1 Pixel Tube, FP1 Titan Tube,  
FP2 Helios Tube, FP3 Hyperion Tube

Date: 01/28/21 Version: 1.0



Essential grip for mounting Astera tubes to walls, truss and other structures.

### Holder on Tube



## SPECIFICATIONS

Order Code Holder	AX1-H
Order Code Holder Rubber	AX1-H-R
Dimensions (mm/inch)	51.6 x 52.5 x 15 / 2.03 x 2.06 x 0.6
Thread	M5
Weight (kg/lbs)	0.045 / 0.09
Material	Stainless Steel

## DRAWINGS

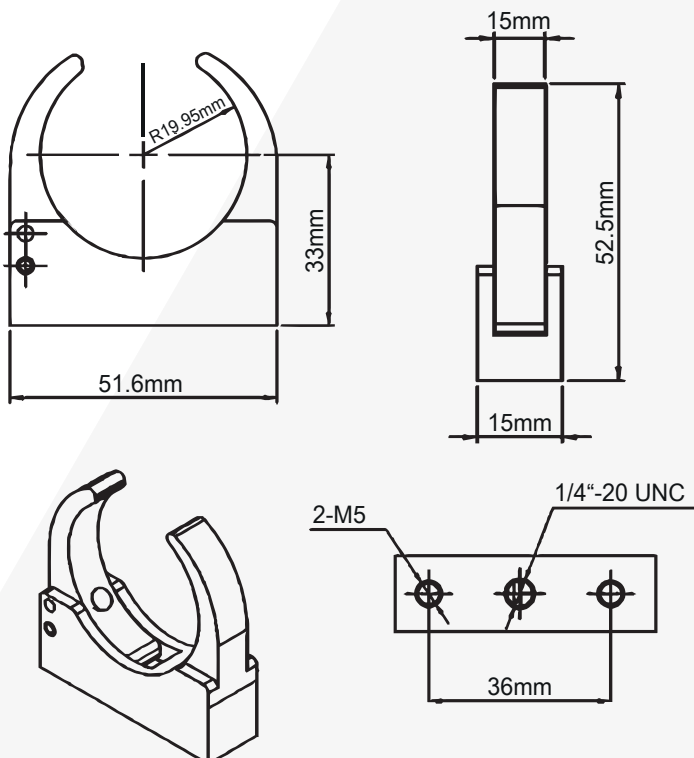

## USE CASES

### Holder on WingPlate

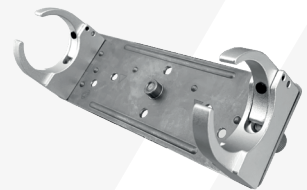

### Tube mounted on truss with Holder and SuperClamp



### Holder for hanging / safety





Compatible with:  
AX3 bracket, AX3 housing (sides), AX1/  
Tube Holder, AX1/Tube WingPlate and others



Double ended Spigot - essential grip for mounting  
Astera tubes and spotlights to walls, truss and other  
structures.

SPECIFICATIONS

Order Code	AX1-BLT
Upper thread	1/4"-20
Lower thread	3/8"-16
Dimensions (mm/inch)	Ø19 x 68 / Ø0.75 x 1.3
Weight (kg/lbs)	0.06 / 0.13
Material	Stainless Steel

DRAWINGS

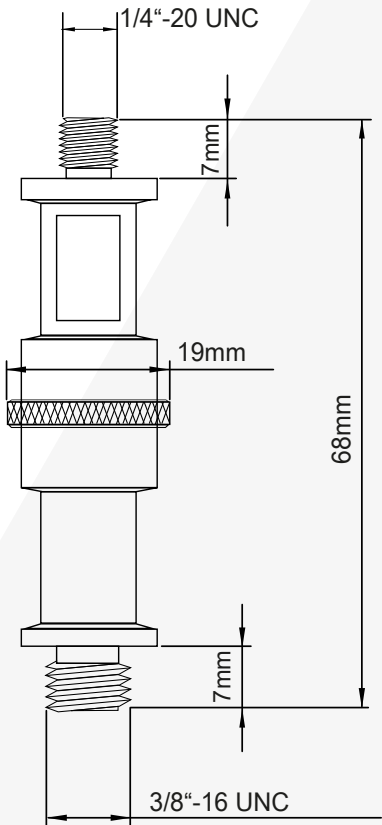

USE CASES

Mount WingPlate

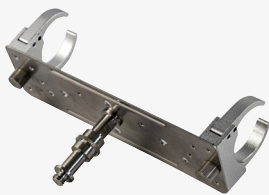

Mount Holder

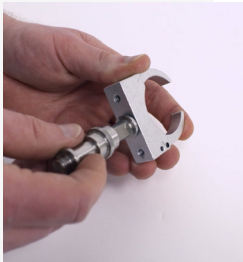



# DATASHEET

# TubeStand

Compatible with:  
AX1 PixelTube, FP1 TitanTube, FP2 HeliosTube

Date: 01/28/21 Version: 1.0



Metal Stand to stand the AX1, FP1 and FP2 upright onto stages, at entrances or behind fabric etc.

### Stand folded



## SPECIFICATIONS

Order Code	AX1-STD
Dimensions folded (mm/inch)	44mm x 20mm x 220mm
Dimensions unfolded (mm/inch)	44.20mm x 441.6mm
Thread	M5
Weight (kg/lbs)	0.31 / 0.68
Material	Stainless Steel

## DRAWINGS

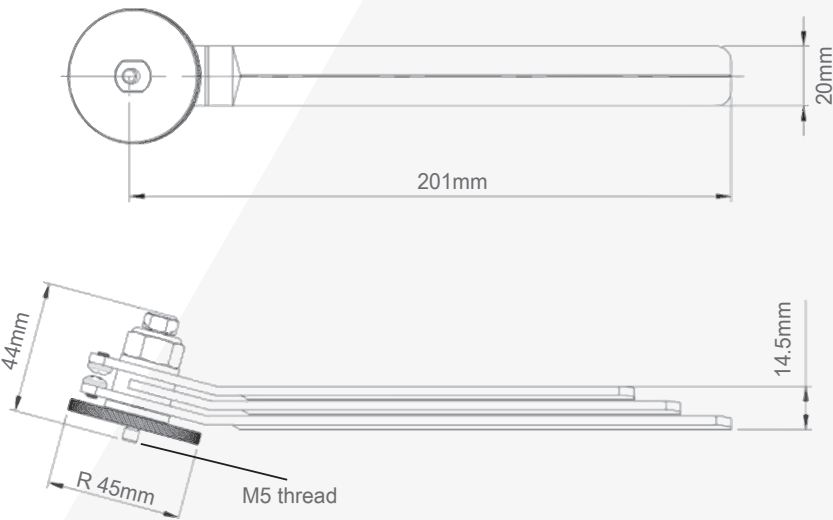

## USE CASES

### Stand with Tube mounted

